

# MFace 302

## Multi-biometric Identification Time Attendance and Access Control Terminal



It Integrated with 800MHz high speed Multi-Bio processor and high definition infrared camera enables user identification in the dark environment. Face and fingerprint multi-biometric identification methods make it more applicable. Multi-model communications consisting of RS232/485, TCP/IP and Wi-Fi/GPRS (optional) allow an extremely easy data management. Optional built-in 2000 mAh battery eliminates the trouble of power failure.

### Features

- Identification methods include Face, Fingerprint/RFID and/or Password
- Elegant ergonomic design
- 4.3" TFT touch screen is user-friendly and very intuitive
- 6 user-defined function keys
- Contact relays for door access control (wires to door strike or 3rd party panel)
- Web server management software via IE browser.
- Optional extendable scheduled-bell
- Infra-red optical system enables user-identification in poorly lit environments
- Optional built-in battery backup provides approx 4 hours continuous operation
- Optional built-in wireless Wi-Fi or GPRS for wireless communication
- Built-in contacts for 3rd party electric lock, door sensor, alarm, exit button, or bell
- Wiegand Output for connections to 3rd party access control panels

### Configuration

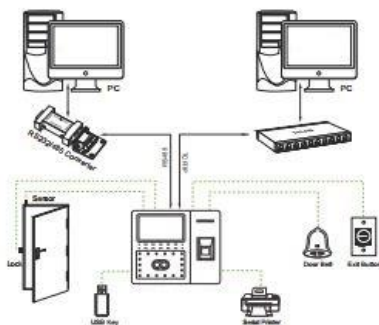

### What's in the Box

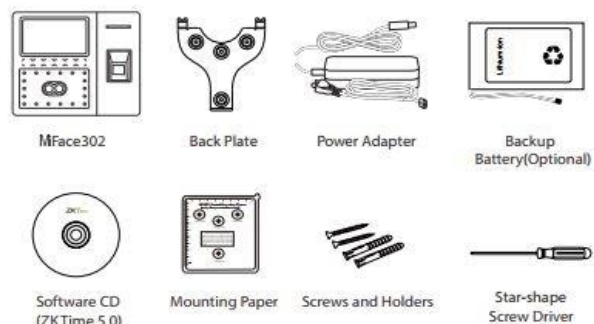

# Specifications

Display	4.3 TFT touch screen
Face capacity	400 (1:N)
Fingerprint capacity	2,000
ID Card capacity	10,000
Logs capacity	100,000
Algorithm Version	MFace 7.0 & Finger 10.0
2000mAh backup battery	Optional
Communication	TCP/IP, RS232/485
USB-HOST	Two USB-Host
Wireless Wi-Fi	Optional
Time attendance Standard functions	ID Card(Optional), Automatic Status Switch, Self-Service Query, Work Code, T9 input, 9 digit user ID, DLST
Access control interfaces for	3rd party electric lock, door sensor, exit button
Wiegand Signal	Output
Optional functions	Serial printer, Mifare card, Extendable Scheduled-bell, Short Massage, Web-server, GPRS
Power supply	12V DC 3A
Verification Speed	≤2 sec
Operating temp	0 °C ~ 45 °C
Operating Humidity	20% ~ 80%
Dimension(W×H×D)	193.6 × 146.8 × 111 mm
Gross Weight	1.9 kg

## Singapore Office

Magicsoft Asia Systems Pte Ltd  
21 Bukit Batok Crescent  
#09-84 Wcega Tower  
Singapore 658065

Tel: +(65) 65157087  
Fax: +(65) 65157086  
Email: sales@magicsoft-asia.com

## China Office

Shantou Mingji Co.,LTD.  
A-13 Rm401, A Building,  
International Commercial Building,  
Jinshadong Rd, Shantou,  
Guangdong, China 515000

Tel (Mainland of China): +(86) 754 8836 6694  
Tel (Hong Kong): +852 8172 0085  
(Singapore): +(65) 6379 9366  
Email: sales@magicsoft-asia.com